

Sensory Map

This map is designed for those on the autistic spectrum, and those with sensory concerns to help them prepare for their visit.

It covers light, sound and touch

Lauderdale *House*

Ground Floor - Light

The galleries and the house in general is well lit by both natural and artificial light. When the gallery is closed, the shutters are drawn, which means the Lower Gallery can get very dark in the evening. The lights by the toilets are on automatic sensors, and come on when you approach. The lights that are on automatic sensors are those on the back staircase

-  Very bright
-  Bright
-  Dim

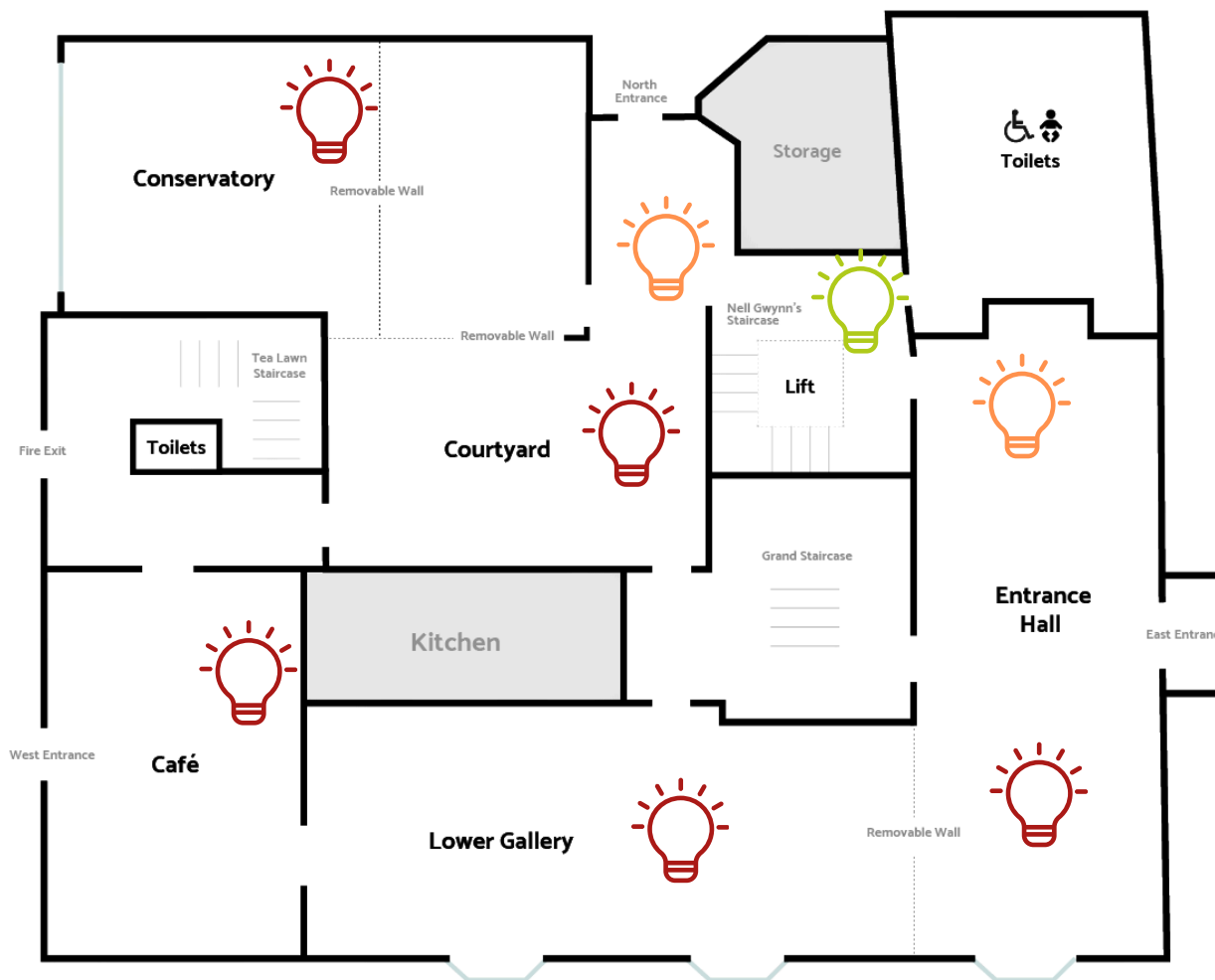



Ground Floor - Sound

The House is generally quiet, and there is usually only very loud noise if there is an event going on. Very loud areas include the cafe, which gets busier in the afternoon and on weekends, the kitchen (not accessible to the public) and the back of the Lower Gallery that leads into the cafe. When this door is shut however, the noise is reduced.



Ground Floor - Touch

There aren't many things to touch in the House. We do have one touchscreen in the Entrance Hall that provides interactive information for visitors. It has no sound. There is also Nell Gwynn's Bath just to the right of the touchscreen, as well as the exposed original Tudor fireplace and wooden beams in the Lower Gallery, that visitors are welcome to explore.

-  Touchscreen (no sound)
-  Non-digital Interactive

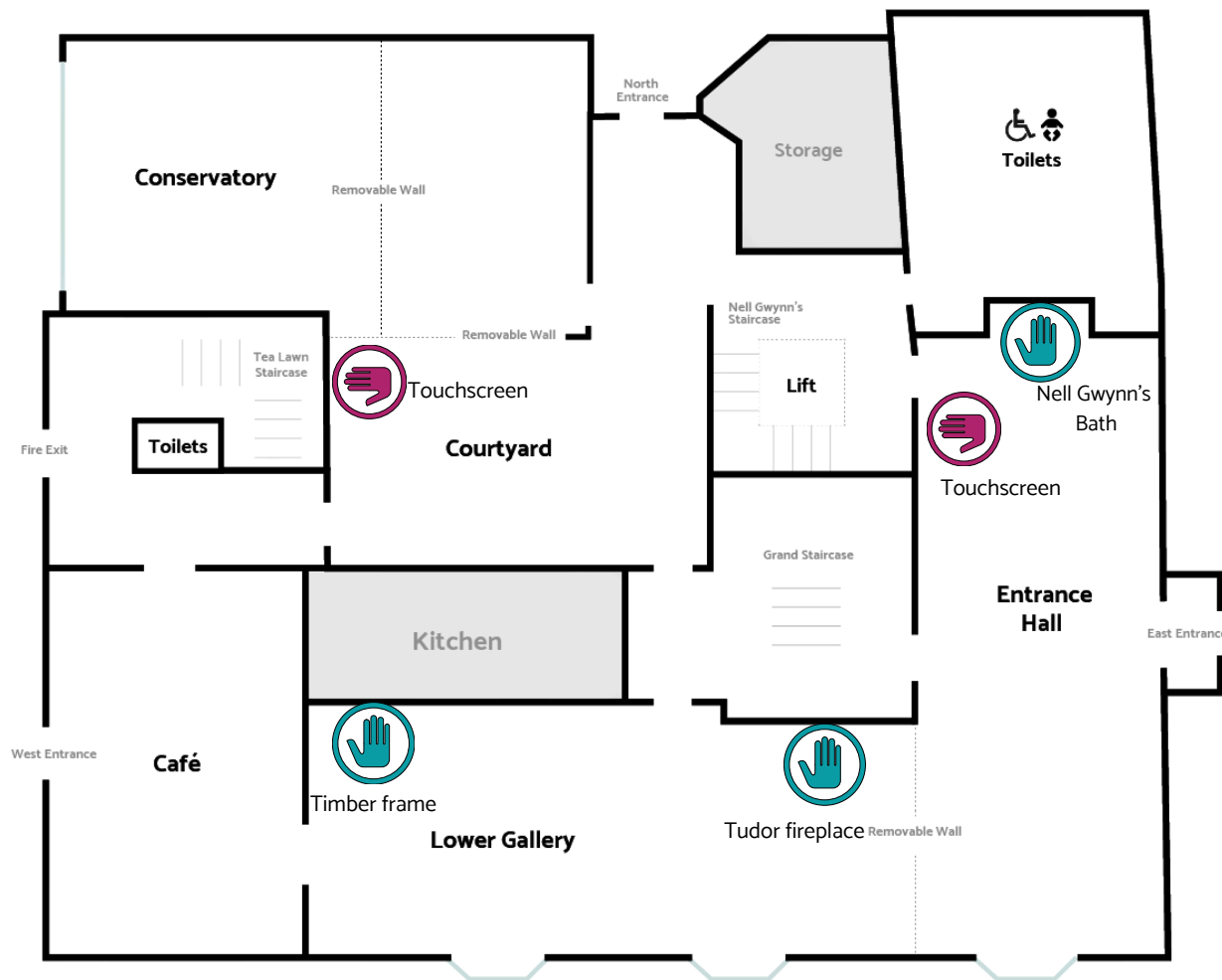

First Floor - Light

The galleries and the house in general is well lit by both natural and artificial light. The Long Gallery gets good natural light during the day. The Upper Gallery lights are always on when the House is open. The lights by the side stairs corridor are sensor controlled, and will turn on with movement.

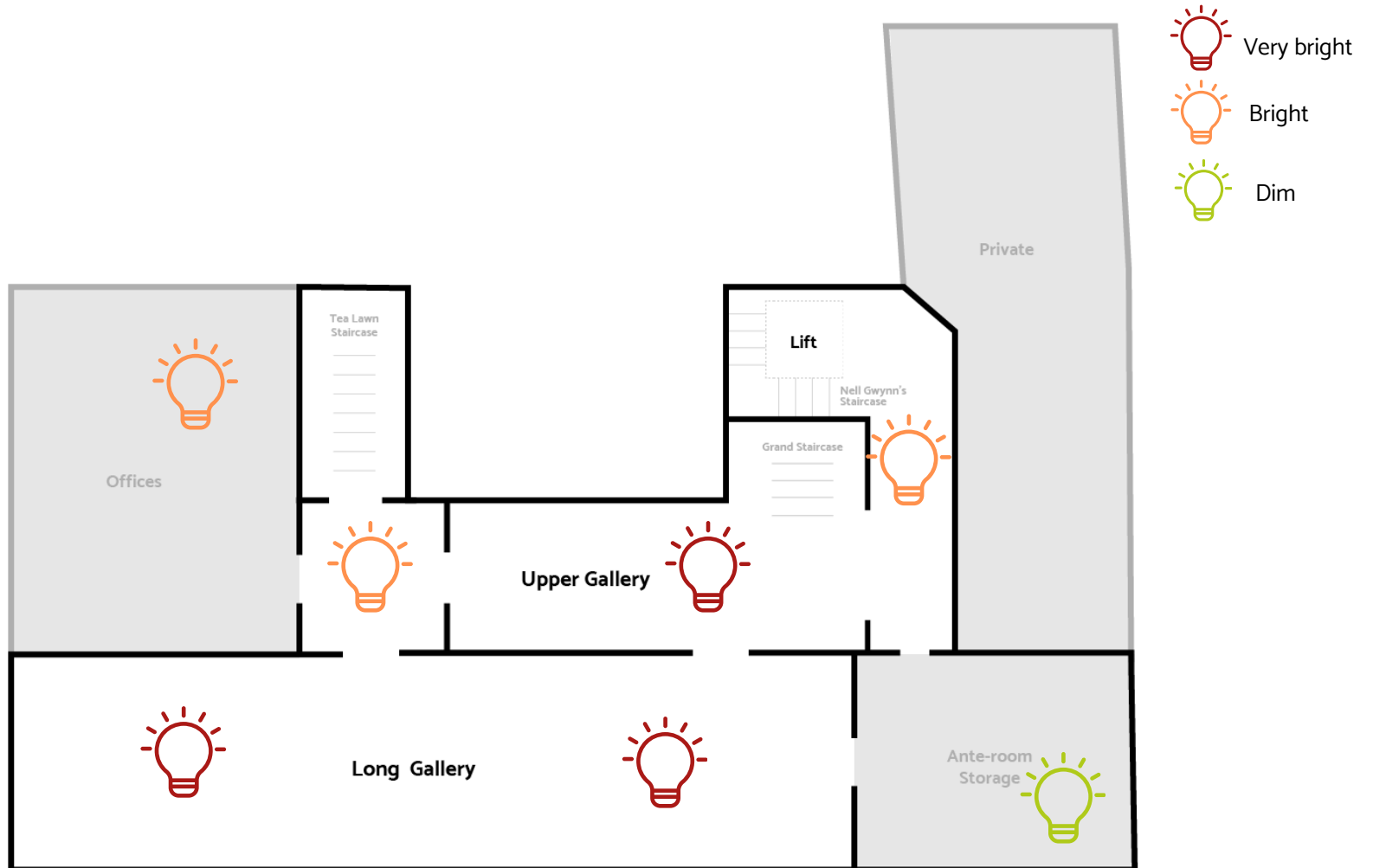

First Floor - Sound

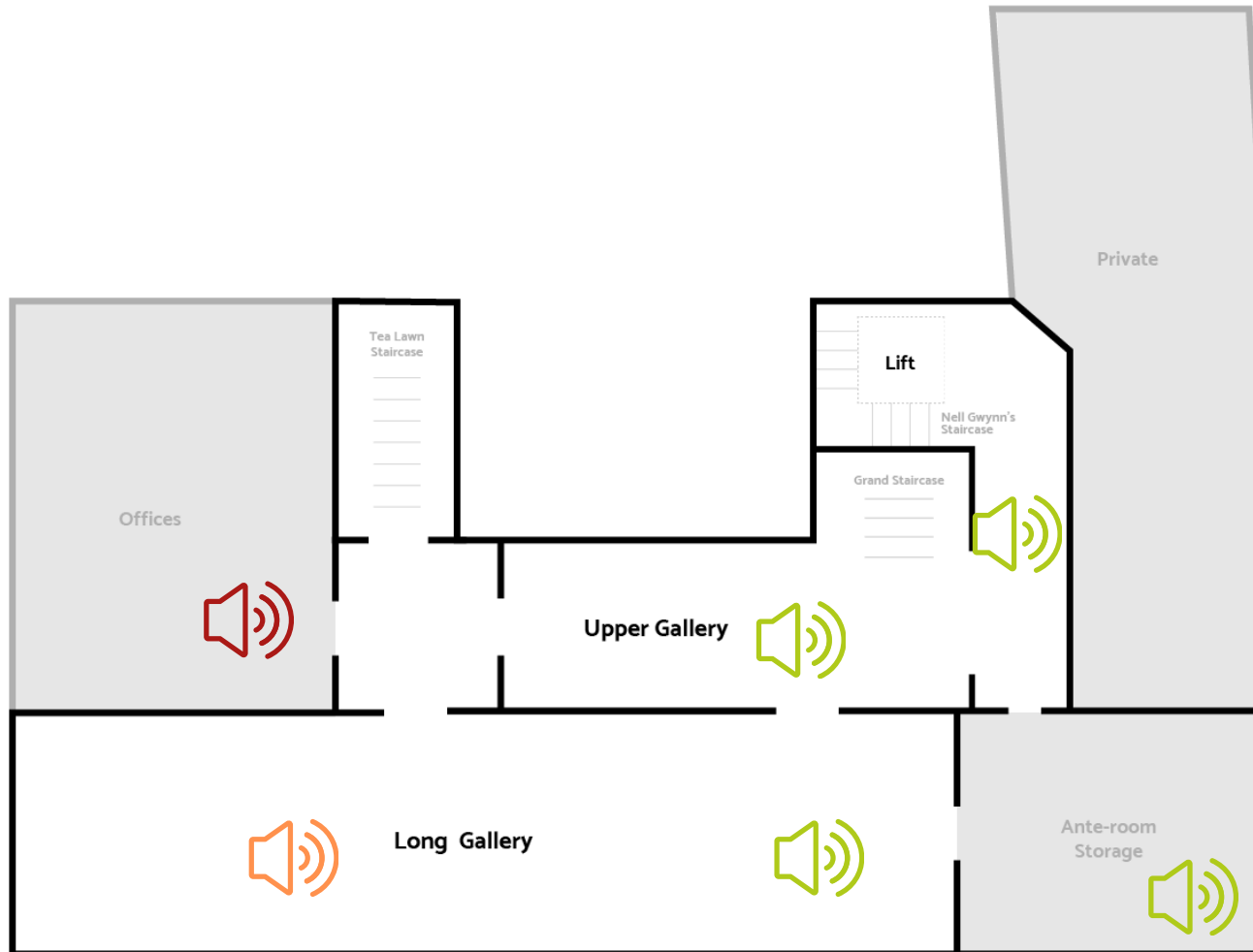

The First Floor is always very quiet. The only time there may be some noise is if there is a class or event in the Long Gallery. There is some noise that comes from the offices though this is predominantly phones ringing.

-  Very Loud
-  Noisy
-  Quiet



First Floor - Touch

There is one touchscreen in the Upper Gallery, that is identical to the one in the Entrance Hall downstairs. There is also the timber beams and Tudor fireplace in the Long Gallery that visitors are welcome to explore.

-  Touchscreen (no sound)
-  Non-digital Interactive

